

XERION 3800
TRAC / TRAC VC

CLAAS

Simply unrivalled.



Large 4x4 tractors:
Unrivalled performance





Simply unrivalled.

Productivity is the key to remaining competitive – productivity means success, and success means growth. As more and more land is farmed in large-scale operations, and contractors take on ever more jobs and customers, a critical land area is suddenly reached. The problem faced in this regard is twofold: on the one hand, the overall acreage remains too small overall to justify the investment in a self-propelled machine, while on the other, the area is already far too large for a 300-hp tractor to be used for profitable farming.

There is one machine that rises to all these challenges – the XERION from CLAAS. This is the machine for achieving high acreages, high productivity and cost-effectiveness. Operators around the world and from a wide variety of farming operations appreciate the large 4x4 tractor design, technology and versatility of this machine.

Today, the XERION is a solid contender in the farming world. Take the time to investigate it further – it will be time well spent.

Unrivalled value.





Contents

Unrivalled power.

| | |
|---------------|----|
| TRAC concept | 8 |
| Engine | 10 |
| Transmission | 12 |
| Full frame | 13 |
| Driving modes | 14 |

Unrivalled flexibility.

| | |
|----------------------|----|
| Axles and steering | 18 |
| Hydraulics | 20 |
| Linkage/PTO | 22 |
| Ballasting and tyres | 24 |

Unrivalled convenience.

| | |
|--------------|----|
| Cab comfort | 28 |
| Pivoting cab | 30 |

Unrivalled intelligence: EASY.

| | |
|-------------|----|
| CEBIS | 36 |
| CSM, ISOBUS | 38 |
| GPS PILOT | 40 |

Unrivalled deployability.

| | |
|----------------------|----|
| Servicing | 42 |
| FIRST CLAAS SERVICE® | 44 |

| | |
|----------------|----|
| Specifications | 47 |
|----------------|----|

Unrivalled power.

Powerful intelligence.

There's more to an efficient drive system than just the engine. In CLAAS POWER SYSTEMS (CPS), we have brought together top-quality components to create a drive system that is in a class of its own – one that always delivers the most efficient power when needed. CPS is ideally matched to the working system, equipped with fuel-saving technology that quickly pays for itself.

A harmonious blend of power and intelligence – the four equal-sized tyres transfer the power effectively to the ground. Power, as and when its needed – we call it "power intelligence".

Engine: CAT C9 6-cylinder engine, turbocharger, charge-air cooler with
max. output of 279 kW / 379 hp as per ECE R 24
max. output of 285 kW / 388 hp as per ECE R 120 (97/68 EG)

Standard reversible fan delivers full cooling power

Fully integrated front linkage, 8.2-t continuous lift capacity

Robust full frame

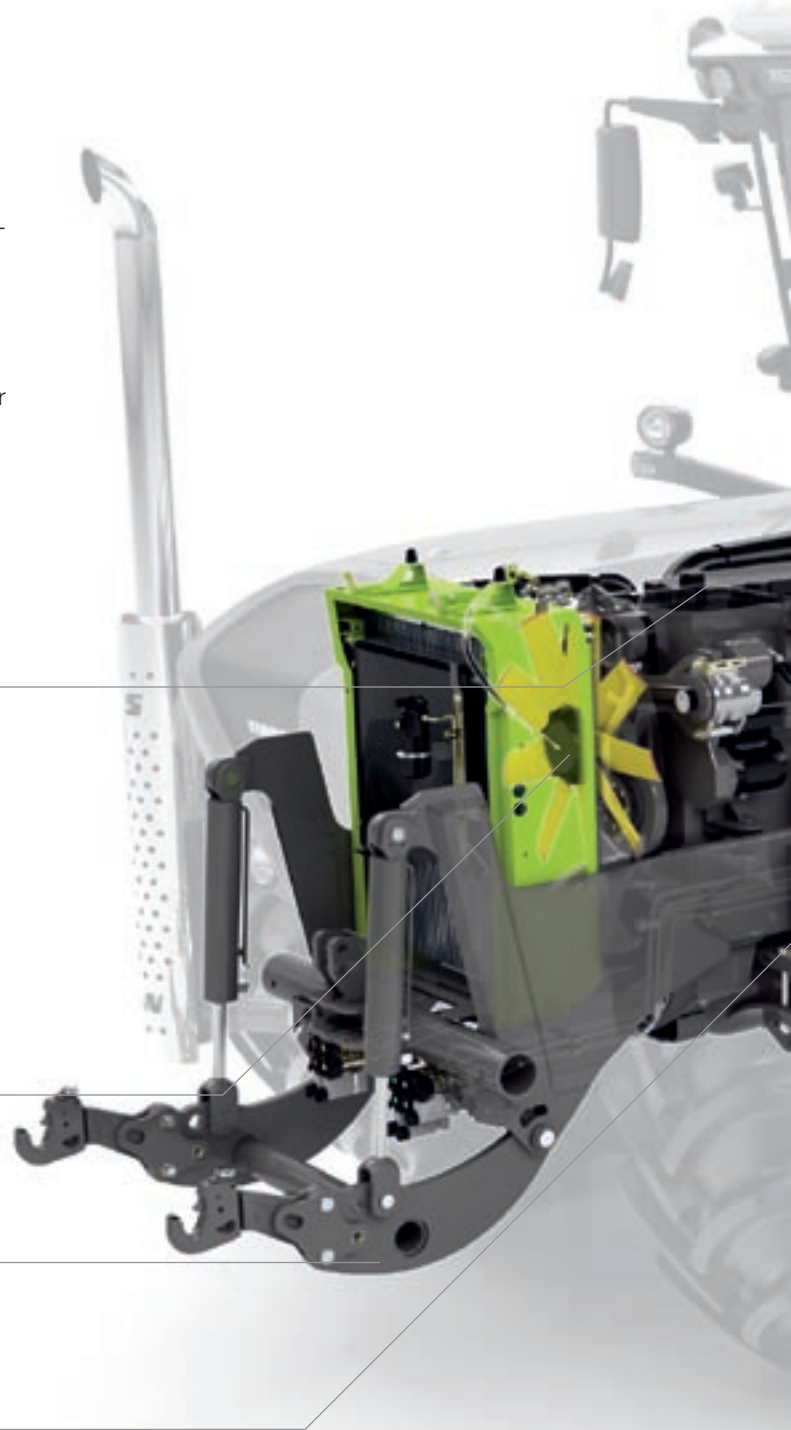

CPS | CLAAS
POWER
SYSTEMS

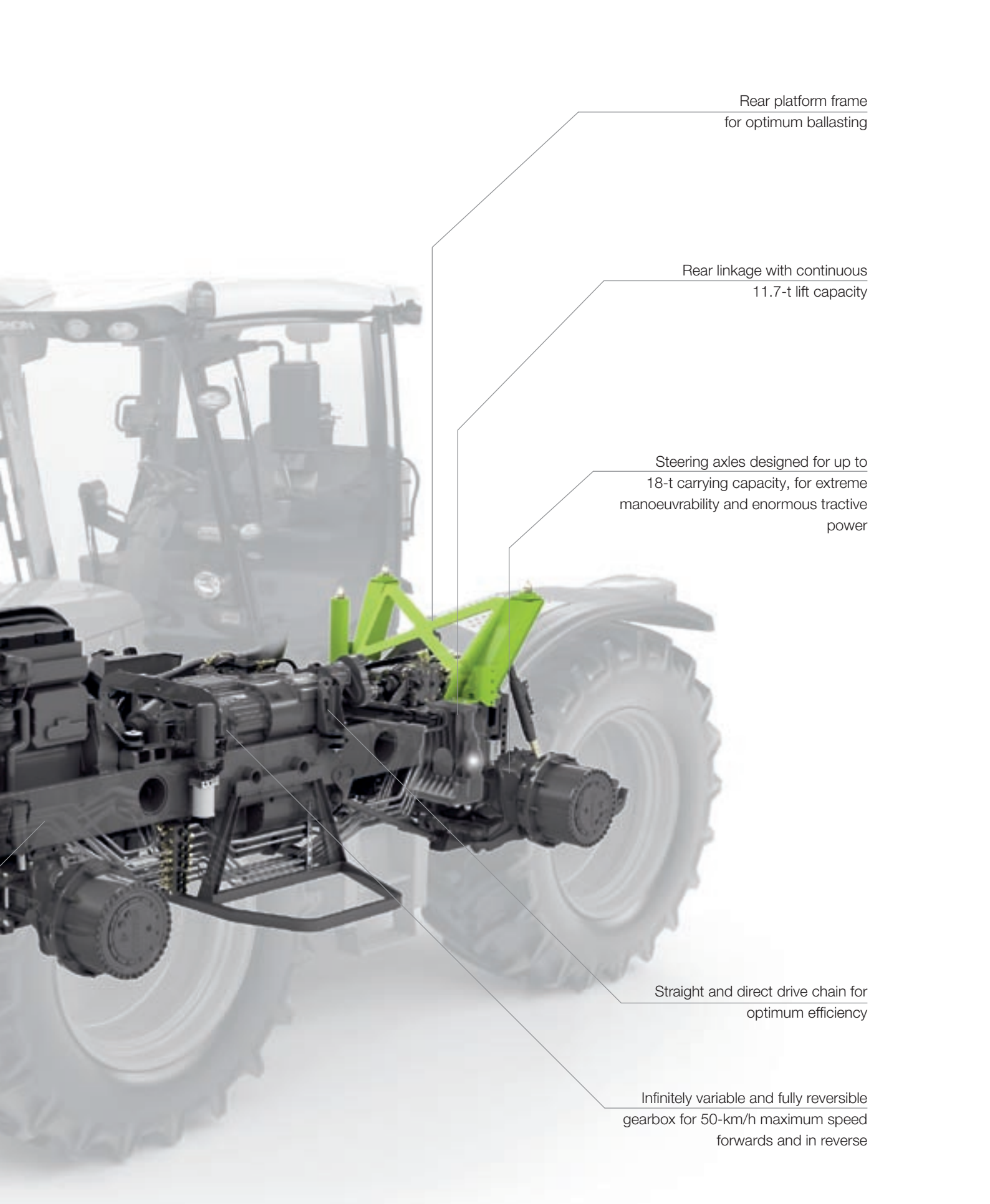

Rear platform frame
for optimum ballasting

Rear linkage with continuous
11.7-t lift capacity

Steering axles designed for up to
18-t carrying capacity, for extreme
manoeuvrability and enormous tractive
power

Straight and direct drive chain for
optimum efficiency

Infinitely variable and fully reversible
gearbox for 50-km/h maximum speed
forwards and in reverse

Unrivalled power



Unrivalled tractive power.

The challenge faced by CLAAS engineers in developing the XERION proved as great as the machine itself. The task involved designing a vehicle capable of rising to a challenge otherwise fraught with difficulty for standard 300-hp tractors without ballast weights and dual wheels: to transfer enormous power to the ground without damaging the soil.

Larger contact area.

Four equal-sized wheels up to 2.05 metres in diameter visibly set the TRAC concept apart. The benefits include:

- Maximum contact area at properly adjusted tyre pressure
- Reduced wheel slip
- Reduced soil compaction

Unrivalled efficiency.

Another feature of the TRAC concept is its full-frame design, which offers ideal weight distribution with 53 percent on the front axle and 47 percent on the rear axle (static):

- Perfect traction
- Greater efficiency

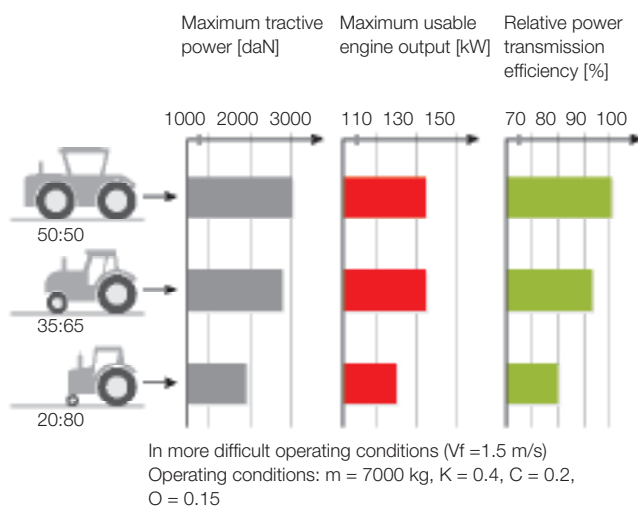

The effects of tractor construction and drive design (identical overall weight)

Source: FAL Braunschweig, Prof. Dr. Harms

The ground yields to its mighty power.

Unrivalled load capacity.

The full frame is also capable of taking much greater machine weights in its stride. The following are deemed viable and permissible overall weights:

- Up to 18 tonnes on the road (depending on national regulations; higher weights possible with special approval)
- Up to 36 tonnes in the field

The tare weight is 13 tonnes. With just two tonnes of extra weight on the front axle, the XERION delivers substantially greater tractive power than any other standard machine.

Superior visibility and manoeuvrability.

Other advantages of the TRAC concept:

- The central cab position ensures an unobstructed view of all implements
- Impressive manoeuvrability and agility, thanks to four-wheel steering
- Tight, 12-metre turning circle (depending on tyres)

Contact area of all four wheels.¹

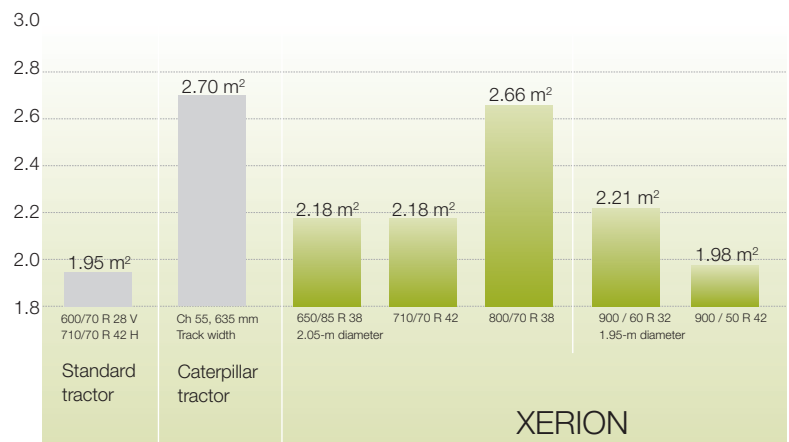

¹ Manufacturer information from Goodyear, tyre pressure 1 bar, wheel loads 6.1 t (or 4 t on front tyres on standard tractor)

Torque to spare.

Engine.

You'll be able to move heaven and earth with the XERION and have fun doing it, thanks to the enormous torque of the 8.8-litre, six-cylinder CAT engine:

- Max. 379 hp at 1,800 rpm (ECE R 24), max. torque 1,620 Nm at 1,400 rpm
- Powerful PTO operation

XERION 3300 engine performance curve.

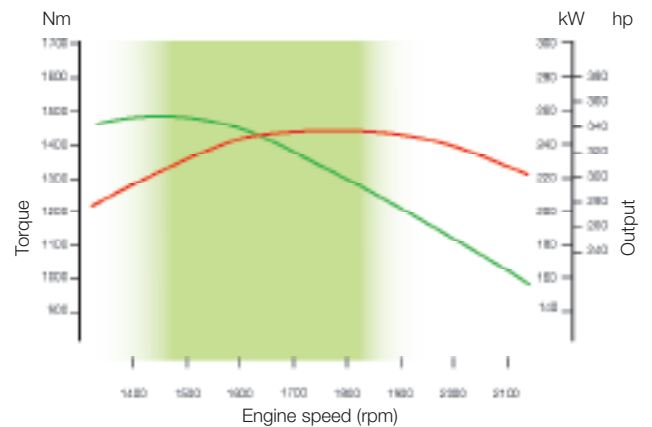

XERION 3800 engine performance curve.

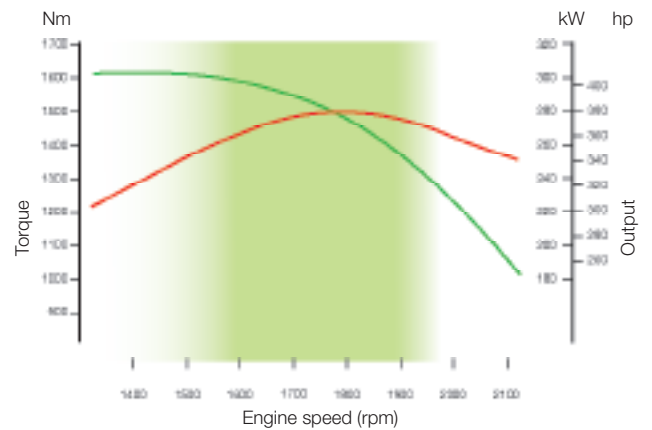

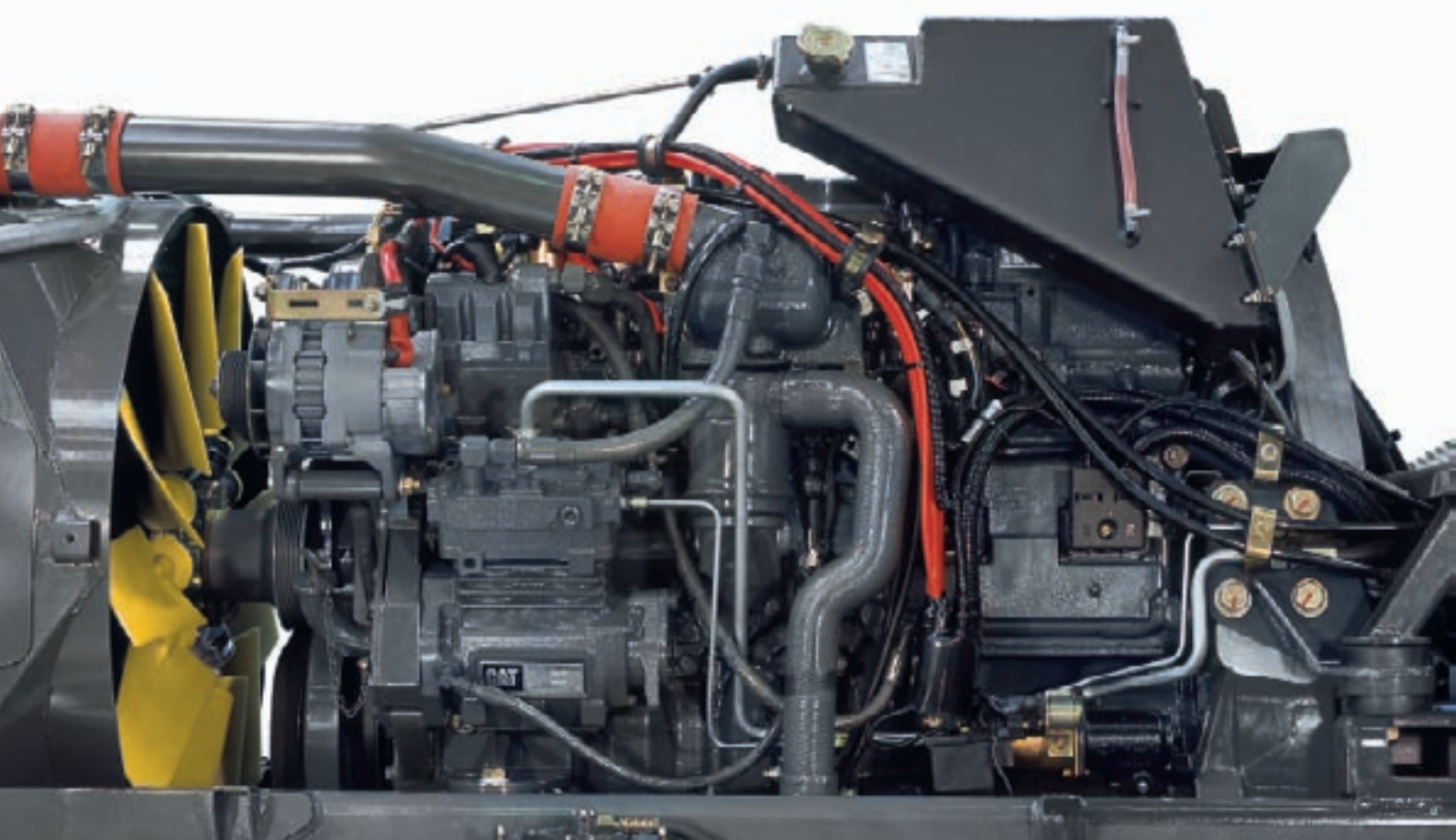

Efficient HEUI injection system.

Hydraulically actuated, electronically controlled jets provide the ideal injection pressure to help you save fuel.

Perfectly positioned air intake system.

The air intake system on the XERION is located on the cab post, since the air at the top is cleaner than the air at the bottom. This means:

- Less maintenance
- Greater output
- Extended service life

Reverser fan as standard.

In standard operation, the setting angle is adjusted according to cooling requirements. To clean the radiator, the fan blade is pneumatically reversed. This means:

- Less maintenance
- Full cooling capacity at all times
- No need to leave the cab





CMATIC – infinitely variable transmission technology for extreme requirements.

ZF Ecom 3.5 guarantees an extremely efficient conversion of installed engine power to muscle power:

- Infinitely variable and smooth shifting through four driving ranges in both directions of travel without cutting the power flow
- Reaches 50 km/h while operating at a reduced, fuel-saving engine speed of between 1,500 and 1,700 rpm
- An auxiliary output shaft to drive the power hydraulic system is available as an option

Direct driveline.

XERION offers a clearly defined and structured driveline, which features a permanent all-wheel drive capability and copes well with the most demanding of loads, such as when operating a front-mounted forestry tiller:

- Straight driveline, engine power transmitted to the gearbox via a short shaft
- Highly efficient power transfer
- Axial and transverse differential lock
- Direct power transfer to PTO shaft stub

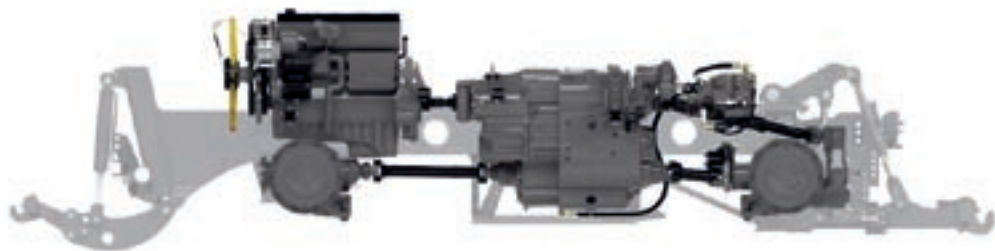

Performance stems from power, and productivity stems from performance.

Full support frame.

In conventional tractors, owing to the chassis construction, the engine and transmission inevitably assume a supportive function. The XERION is different: this machine is equipped with a modular and full support frame, making the contribution of the engine and transmission in this regard redundant. These are instead mounted on silent blocks:

- Vibration-free cab
- Perfect accessibility
- Simple maintenance

Front and rear linkages are integrated in the frame:

- High load-bearing capacity for implements
- Up to 11.7 t at the rear
- Up to 8.2 t at the front

The frame also allows heavy ballasting, and thus a high permissible overall weight of up to 23 tonnes at 50 km/h.



Transmission
Full frame

Simply a question of configuration – driving modes.

Engine and transmission management.

The XERION offers four driving modes to suit various conditions. Simply select the strategy that best suits the current application.

1. AUTOMOTIVE.

- Activated automatically
- Only the accelerator pedal is used, as in an automatic passenger car
- Superior driving comfort on the road
- Optimum fuel efficiency

2. CRUISE CONTROL.

- Activated using the drive control lever
- Maintains a constant speed
- Offers two memory settings for forward and reverse
- Ideal when drilling, for example – the operator can concentrate fully on the implement





3. MANUAL.

- Set via CEBIS
- Engine speed and gear ratio selected independently by operating the pedal and drive control lever
- Perfect matching of ground speed to engine speed

4. HAND THROTTLE MODE.

- Activated automatically at constant engine speed
- Ground speed adjusted by changing the speed ratio
- Constant PTO power, e.g. when mowing with the DISCO 9300
- Reduces driver fatigue

Unrivalled flexibility.

CEBIS terminal:

intuitive operation, control and adjustment of the hydraulic system, PTO, power hydraulic system and steering program

Front hydraulics and up to four dual-acting auxiliary spool valves

Six possible steering programs, including auto, four-wheel steer and crab steering modes, GPS-controlled steering

Steering axles with four-wheel steering, permanent all-wheel steering and optional pivoting axle lock: optimum manoeuvrability, straight running

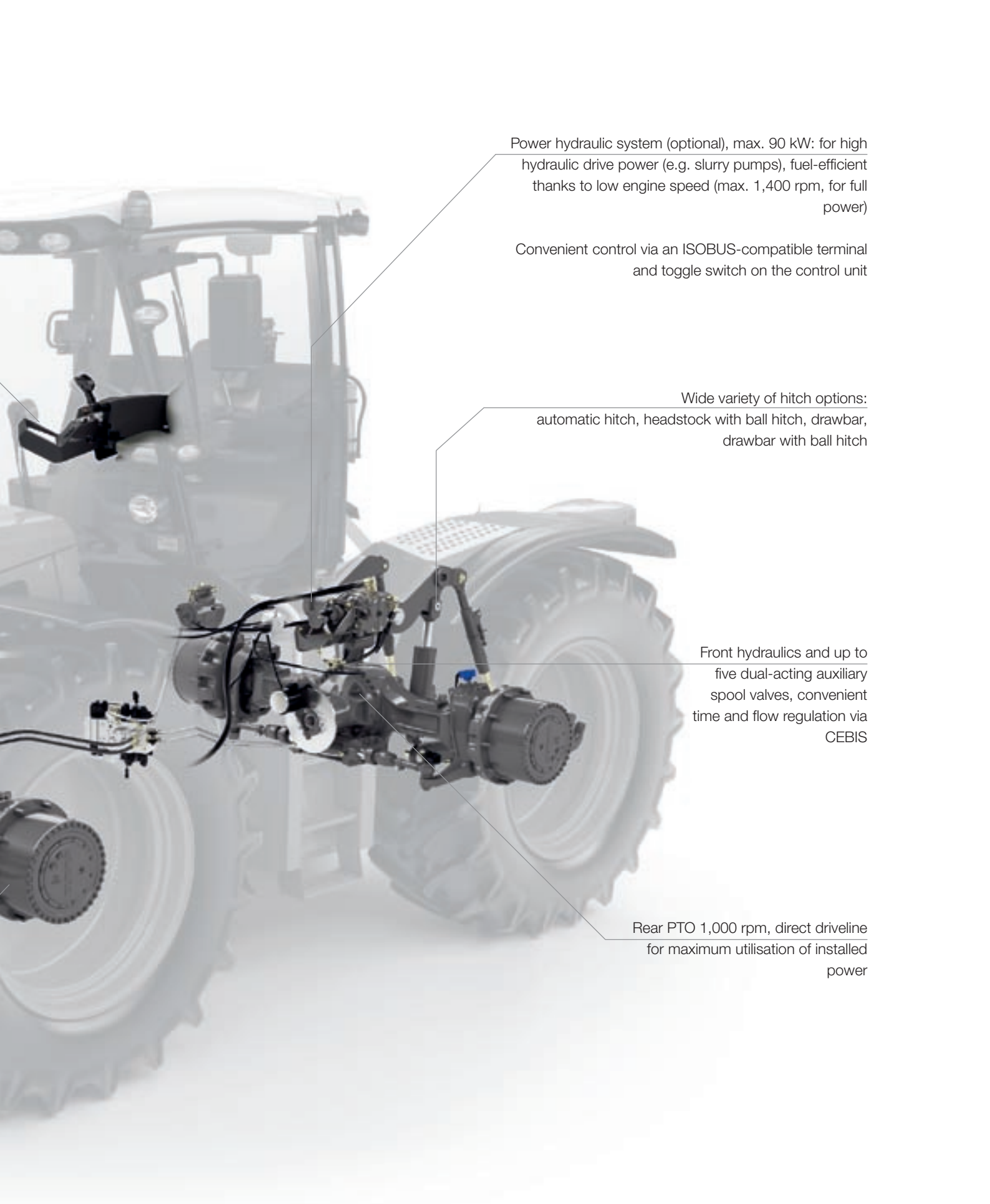

Power hydraulic system (optional), max. 90 kW: for high hydraulic drive power (e.g. slurry pumps), fuel-efficient thanks to low engine speed (max. 1,400 rpm, for full power)

Convenient control via an ISOBUS-compatible terminal and toggle switch on the control unit

Wide variety of hitch options: automatic hitch, headstock with ball hitch, drawbar, drawbar with ball hitch

Front hydraulics and up to five dual-acting auxiliary spool valves, convenient time and flow regulation via CEBIS

Rear PTO 1,000 rpm, direct driveline for maximum utilisation of installed power



Strong axle design.

The axles provide intelligent four-wheel steering and a high load rating of up to 18 tonnes per axle (up to 10 km/h). In addition, the XERION offers a permanent all-wheel drive capability with an axial differential lock and a locking pivot axle (optional). All these features combine to make your daily work significantly easier:

- Optimal mobility
- 12-metre turning circle (depending on tyres)
- Perfect machine control on the road
- Straight running
- No front wheel lead, no loss in drive power – the result: protected grass cover, e.g. during slurry spreading
- Optimum road comfort and ideal traction in the field



Axles that both steer and think.

XERION steering programs.

The XERION offers the ideal steering program to suit any purpose. It provides the standard (road) steering program plus six special steering programs:

- 1 All-wheel steering: both axles are steered simultaneously
- 2 Rear-axle offset steering: the rear axle is offset to prevent slipping on slopes
- 3 Diagonal crab steering: axles are offset up to 75% of the possible steering angle to avoid multipass effect
- 4 Full crab steering: axles are offset for shuttle work
- 5 Drive control lever steering: the machine is steered via the joystick
- 6 Synchronised steering: offset steering pole, e.g. exclusive rear-axle or front-axle steering

Soil protection.

Gentle mode / crab steering can be configured via CEBIS. Afterwards, it's just a matter of flicking the toggle switch.



1. Extend left



2. Central position



3. Extend right

The machine turns through its characteristically tight radius while protecting the soil. The rear axle steers automatically.



Selection menu in CEBIS.

Precision hydraulics.

Powerful hydraulic system.

Two powerful axial piston pumps lie at the heart of the load-sensing system – one supplies the remote spool valves, and the other supplies the machine:

- The first pump supplies the linkage and auxiliary spool valves
- The second pump supplies the oil cooler, steering system and brake
- Operating pressure per pump is max. 200 bar at 190 l/min
- 130-litre capacity
- Up to five dual-acting spool valves
- Time/flow control is infinitely variable via CEBIS
- Flow rate max. 110 litres per spool valve
- Large available oil volume of max. 80 litres





Optional power hydraulic system.

The XERION can be equipped with a third hydraulic circuit if required:

- Max. 260-bar operating pressure
- Max. 235-l/min oil flow
- Max. 90-kW output
- Easy operation via toggle switch

The optional power hydraulic system makes it possible to use the machine for a wide variety of special applications. In combination with a swan-necked slurry tanker, for example, it provides a fuel-efficient alternative to the PTO drive system.

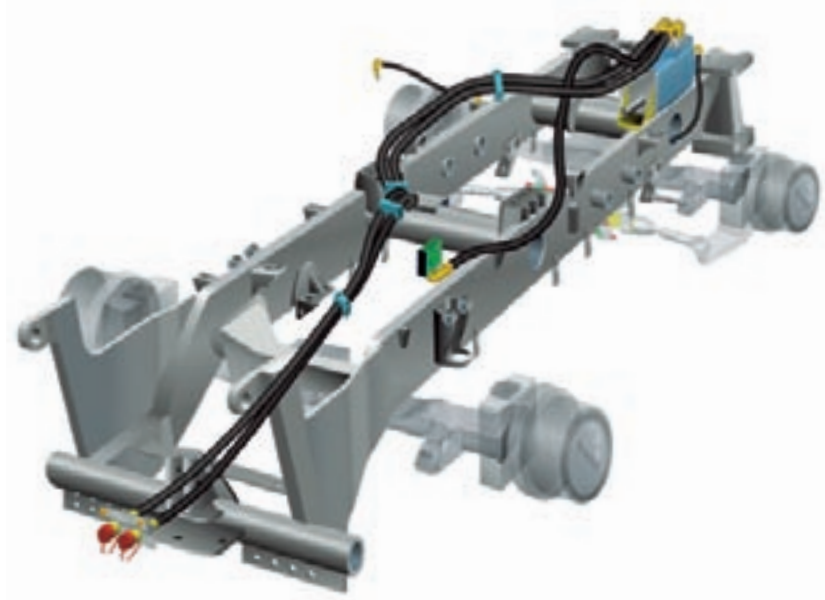



Easy-to-operate rear linkage.

The rear linkage is easily operated via the multifunction lever, while the ELC is conveniently set via the CEBIS system. Both the multifunction lever and CEBIS provide enhanced operator comfort:

- Continuous 11.7-tonne lift capacity
- Cat III or IV are possible
- ELC control from the ground for easy fitting/removal of implements
- Hydraulic stabilisers (optional)
- Vibration damping for implement stability and comfort on the road

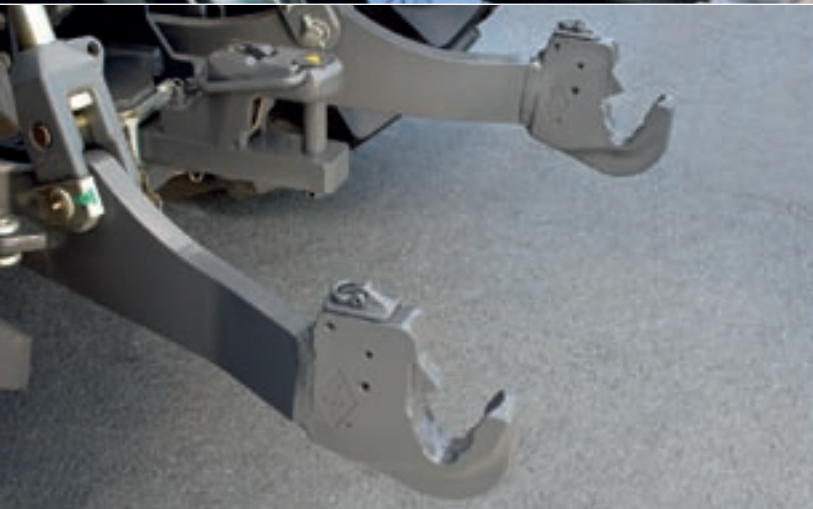

Convenient front linkage.

The front linkage on the XERION can also be operated via the multifunction lever:

- Continuous 8.2-tonne lift capacity
- External operation possible

Drawing on unparalleled resources.



High-performance rear PTO.

The power to the rear PTO flows through a straight driveline to ensure high and constant speeds for applications such as wood chipping.

- 1,000 rpm as standard
- Automatic PTO power-off/on via PTO management

Numerous implement couplers.

The XERION offers a choice of eight different hitch options:

- Automatic hitch
- Headstock with hitch ball
- Tow hitch support, long
- Hitch with 80-mm ball
- Rear ball hitch 110 mm, for up to 15-tonne tongue load
- Drawbar, short/long
- Ball-type drawbar
- CUNA hitch system D3

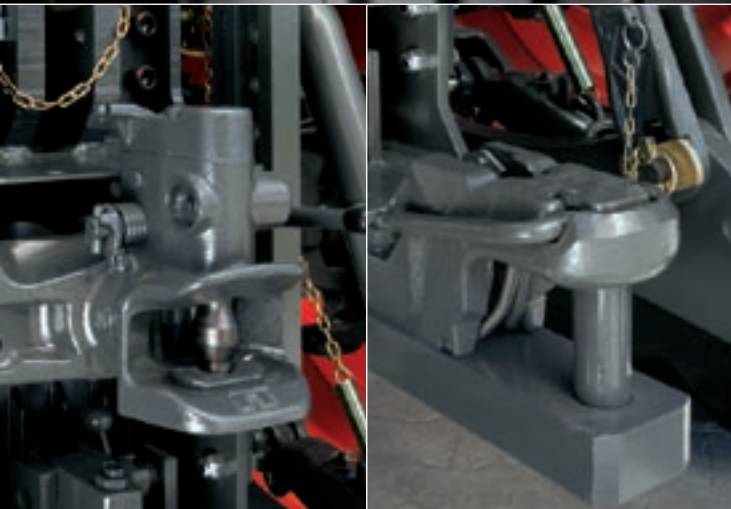

Cleverly balanced – the ballasting.

The perfect ballasting.

The operational weight of the XERION is key to its effectiveness. CLAAS offers a highly sophisticated ballasting concept designed for rapid and simple handling.

- Frame-mounted front ballast with a base weight of 1,800 kg. Up to three additional ballast weights, each weighing 400 kg, can be mounted (max. overall weight 3 tonnes).
- Front ballast for three-point hitch with a base weight of 1,800 kg. Here, too, up to three additional ballast weights, each weighing 400 kg, can be mounted (max. overall weight 3 tonnes).
- Rear ballast with a base plate weighing 200 kg. Up to eight additional ballast weights, each weighing 400 kg, can be mounted on this rear plate.

Both the rear ballast and 400-kg additional ballast weights can be moved effortlessly using a telehandler. A simple locking mechanism is used to lock the additional ballast weights into place.

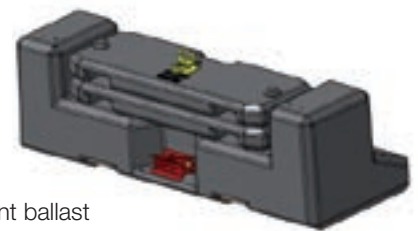

Frame-mounted front ballast



Front ballast for front hydraulics



Rear ballast



Tyres up to 900/60 R 38.

Large tyres with huge contact areas protect the ground and ensure perfect traction:

- Four large, equal-sized wheels
- All popular tyres possible
- No need for dual wheels (advantage for road transport)
- Tyre-pressure control system (optional)

Tyre-pressure control system:

- All air lines are routed to the wheels via the mudguards
- Two-line control system:
 - No air lost from tyres in the event of a control system leak
 - Pressure maintained in remaining tyres if air is lost from one tyre
- Easy operation via a digital, cab-based control system

Unrivalled convenience.

Factory-fitted GPS receiver and terminal:
convenient operation and efficient utilisation of available working widths

Multifunction control lever offers
convenient control of up to 16 functions

Full cab glazing ensures all-round view of
all implements

CEBIS terminal provides a perfect
overview with direct access to the menu
via a rotary switch

Convenient linkage control from the
ground

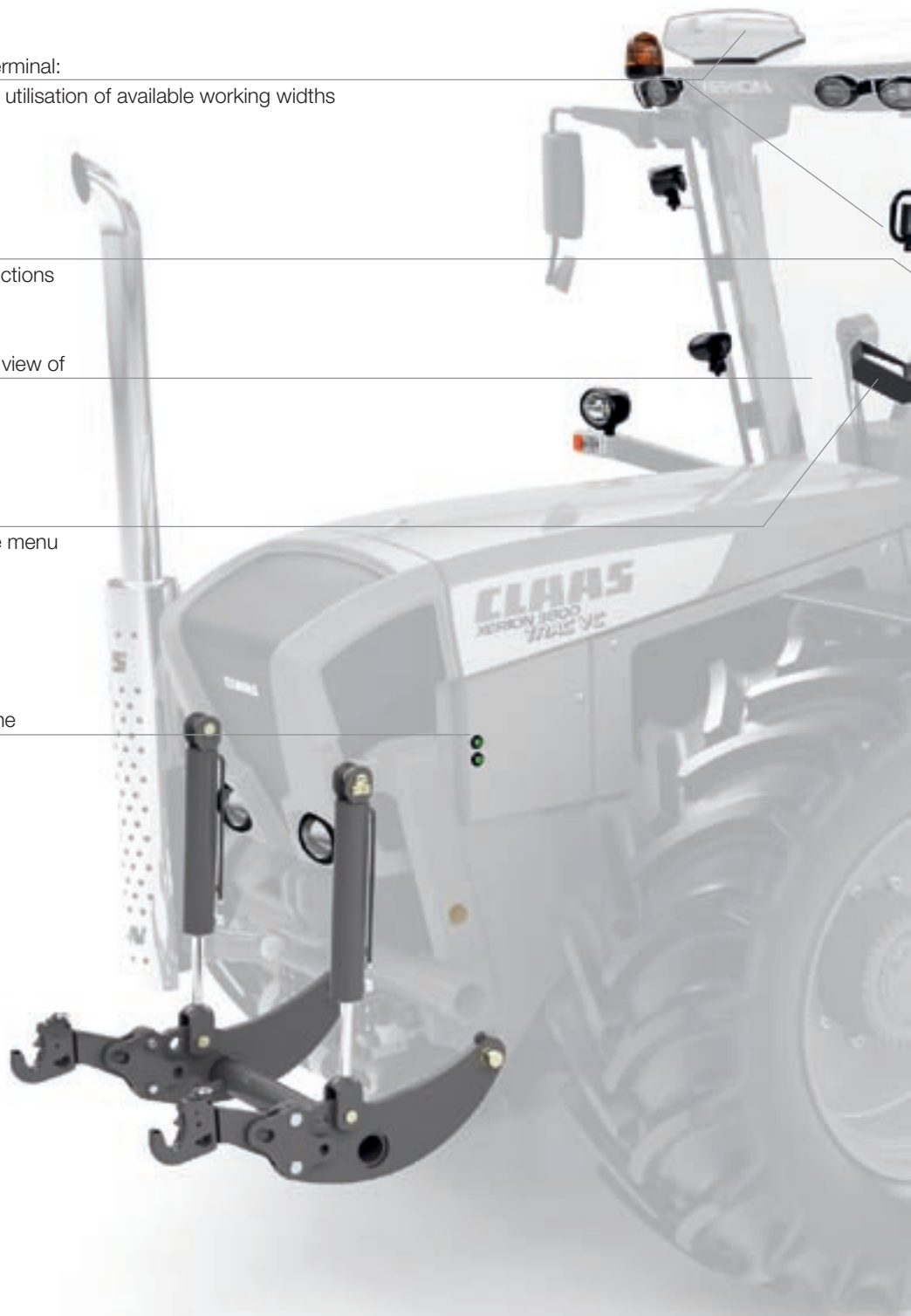

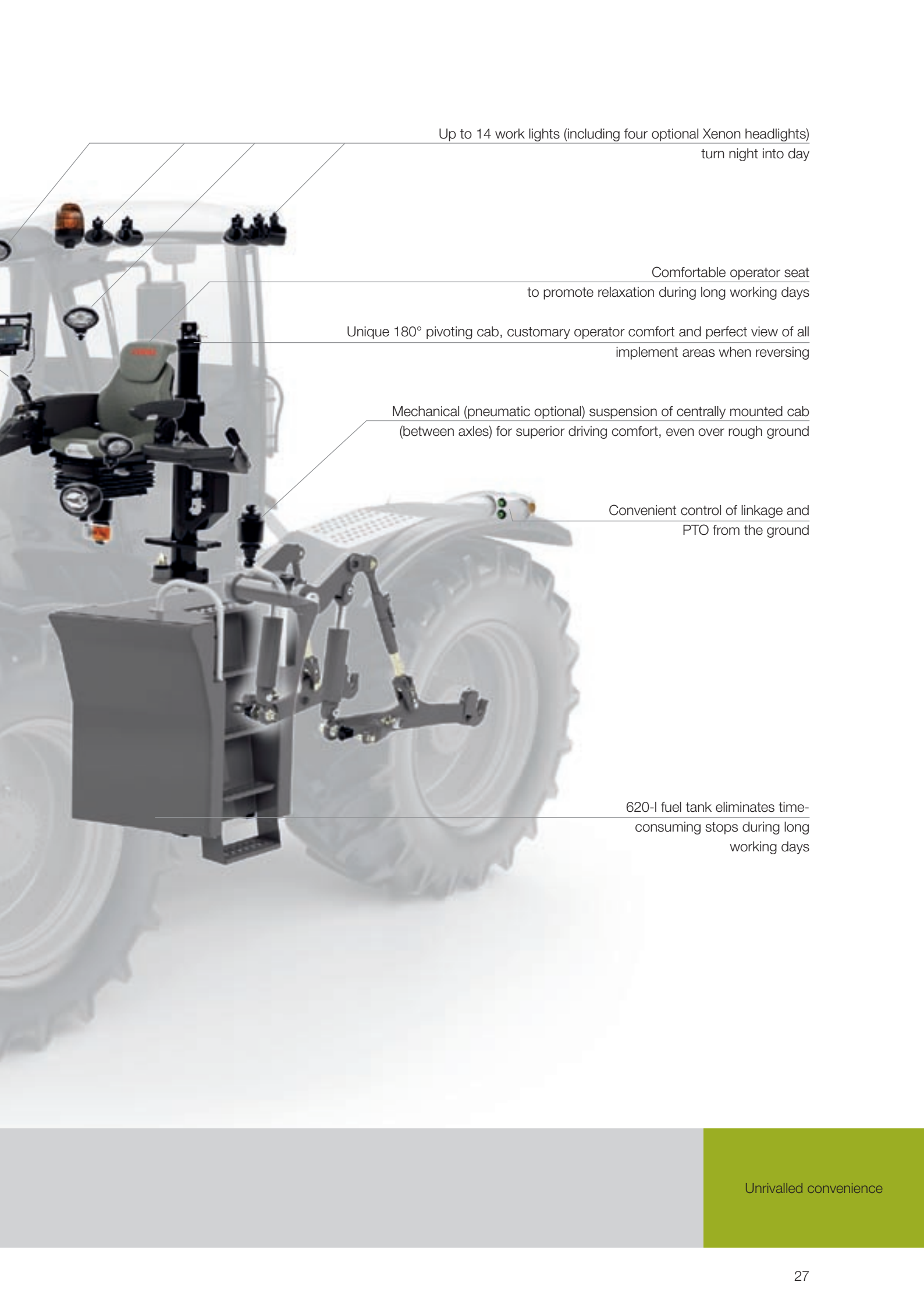

Up to 14 work lights (including four optional Xenon headlights)
turn night into day

Comfortable operator seat
to promote relaxation during long working days

Unique 180° pivoting cab, customary operator comfort and perfect view of all
implement areas when reversing

Mechanical (pneumatic optional) suspension of centrally mounted cab
(between axles) for superior driving comfort, even over rough ground

Convenient control of linkage and
PTO from the ground

620-l fuel tank eliminates time-
consuming stops during long
working days

Unrivalled convenience



Extra-comfort cab.

The interface between human and machine – the workplace. The XERION cab is an instant hit:

- Spacious layout, fully glazed cab, comfortably equipped
- Perfect panoramic view of all implements
- New and slimmer, three-way adjustable steering column for more legroom
- Passenger seat with integral, 27-litre thermo-stowage space
- A/C MATIC climate control with integrated heating
- Ambient/cab temperature indicator
- 7-litre cool box in roof console
- Radio/CD player, optional MP3 player
- Two heated and electric rear-view mirrors and two start-off mirrors



Business Class.



Effective cab suspension system.

The XERION cab suspension system absorbs powerful shocks effectively, giving operators a smooth and gentle ride, even over rough terrain.

- The cab is mounted between the axles, where it is free from vibrations
- Mechanical cab suspension
- Optional pneumatic cab suspension



First-class: comfort seat.

The XERION offers the option of a comfort seat that swivels through 20°.

Others swivel the seat – you swivel the cab.

Pivoting cab (TRAC VC).

Professionals agree that a traditional reverse-drive system is a good compromise, provided the job can be finished quickly. If not, the reverse-drive option on standard tractors will leave you with little option than to put up with being squeezed into an uncomfortable position behind the reversed steering wheel. In the cab of the XERION, everything is where it belongs. All it takes is the push of a button.

- Swivels through 180° at the push of a button
- Swivels in less than 30 seconds
- Full operator comfort in reverse-drive operation
- Excellent view of rear linkage and platform
- All controls remain in their original positions





Perfect visibility.

- Four sun blinds and window wipers
- Unimpeded views in all directions, and of all implement areas

Turn night into day.

For the XERION, the day ends when the work runs out – no matter how long it takes. The lighting system ensures daylight illumination of all implement areas.

- Two front-mounted headlights and eight H9 work lights
- Six rear-mounted H9 work lights
- Two front-mounted and two rear-mounted Xenon lights
- Two rotating beacons for road safety
- Afterglow work lights for safe dismounting at night



Rotating cab

Unrivalled intelligence.

Monitors all machine functions:
CEBIS terminal with integral
implement management system
and CLAAS SEQUENCE
MANAGEMENT (CSM)

Easy maintenance and good
access, thanks to easily removable
bonnet and side panels and 90°
swivel cooling pack

Modern engine technology, featuring
HEUI injection system and boasting
long service intervals





GPS PILOT for added productivity by fully utilising implement widths and reducing operator fatigue

Multifunction lever offers convenient control of up to 16 functions

Automatic linkage and operation of spool valves via the CLAAS SEQUENCE MANAGEMENT (CSM) system

EASY. Simply more.



The name says it all.

The combined electronic competence of CLAAS can be summarised in one word: EASY.

EASY stands for Efficient Agriculture Systems, and it lives up to the name. Equipment settings, steering systems, software solutions and more: EASY makes it all simple. Your systems can be matched perfectly with one another, enabling you to get the best performance from your combines and top results for your operation.

Go on. Go easy.

Four components make one EASY concept, each providing specialist competence and together making a strong team.

- on board – Machine control and performance optimisation directly from the cab
- on field – Increased productivity directly in the field
- on track – Machine monitoring and remote diagnostics
- on farm – Software solutions for your operation

Go on. Go easy.

EASY

Efficient Agriculture
Systems by CLAAS.



"As many as three operators with widely varying qualifications might use one machine. But each must get the best out of the equipment!"

Unrivalled intelligence: EASY

Everything under control – CEBIS.



CEBIS keeps a watchful eye.

CEBIS keeps you informed regarding your XERION's operation:

- Clearly laid-out machine and system settings
- Autonomous diagnosis of connected component, sensor and module functions
- Detects system malfunctions, eliminates costly repairs

CEBIS makes life that little bit easier:

- Operation via just seven buttons and one rotary switch
- Uncluttered terminal, intuitive operation
- Clear graphical layout in full-colour display
- All machine data in one place
- New drivers learn how to operate the machine quickly

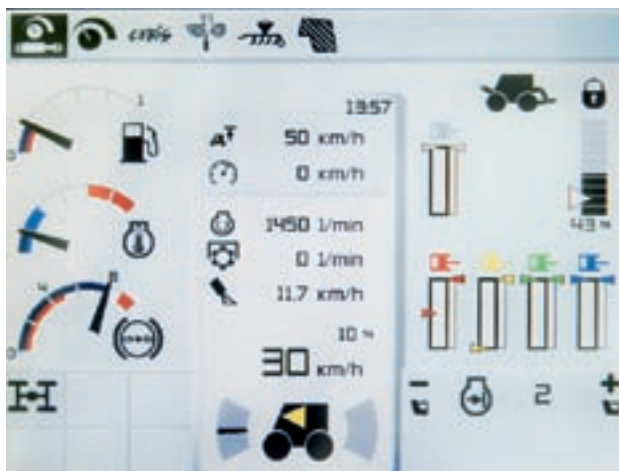

A quick look is all it takes; the CEBIS display gives you an overview of the current processes and status. A driving screen and a harvest screen provide a clear, organised summary of all relevant information.



Tractor management via CEBIS.

Convenient access to all information via the rotary switch, with direct menu access. Rapid adjustment or modification of relevant parameters such as hydraulic connection flow rate.

CEBIS offers a wide range of memory functions that can be called up at the push of a button, including:

- Full machine monitoring
- Hectare counter
- Hour meter
- Total fuel consumption
- Fuel consumption per unit area
- Fuel consumption per working time
- Work order processing
- Engine monitoring
- Service intervals and prompts

Intuitive, intelligent – simply ideal.



Ergonomic multifunction control lever.

The XERION multifunction control lever allows operators to control up to 16 machine functions at the push of a button.

These include:

- Cruise control
- Rear linkage
- Starting off / reversing
- Hydraulic functions
- Autopilot

In addition, there are other function keys (ISOBUS) to which you can program special functions, e.g. lifting out separate DISCO 8550 mowers.

Just climb aboard and drive off.

You'll be operating the XERION intuitively in no time at all.

- Stay relaxed throughout long working days
- All crucial functions under control
- You can concentrate fully on implements and processes

ISOBUS.

The XERION is ISOBUS-compatible with the CLAAS COMMUNICATOR. In combination with CLAAS CEBIS, all applications can be controlled conveniently.

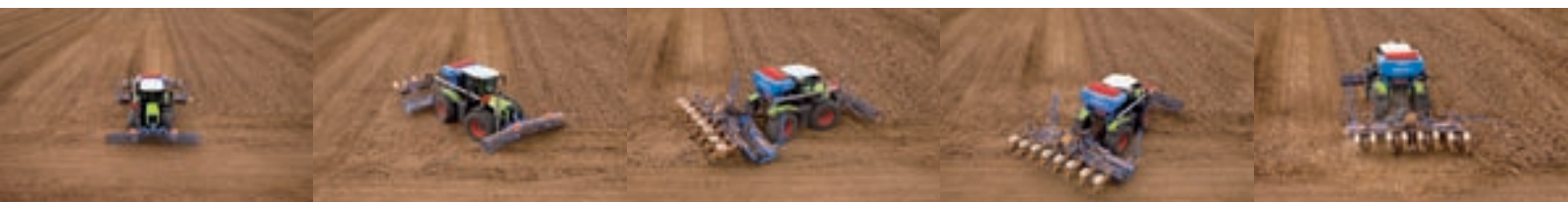



CLAAS SEQUENCE MANAGEMENT.

For easier headland turns, CSM allows the operator to record all operating sequences and retrieve them as required:

- Record four sequences and retrieve these at a later date (F1–F4)
- Display and edit sequences on CEBIS

Implement management via CEBIS.

Enter your implements and the control parameters, and enjoy the benefits of CEBIS:

- Easy retrieval of implement functions
- Optimum settings are also readily available to new operators
- Clear colour display
- Easy operation via keypad and rotary switch

Automatic functions.

There is no need to do everything yourself, as the XERION automatically controls the following machine functions:

- Rear and front linkages
- Up to five hydraulic spool valves
- Rear PTO
- Engine speed, forward speed (cruise control)

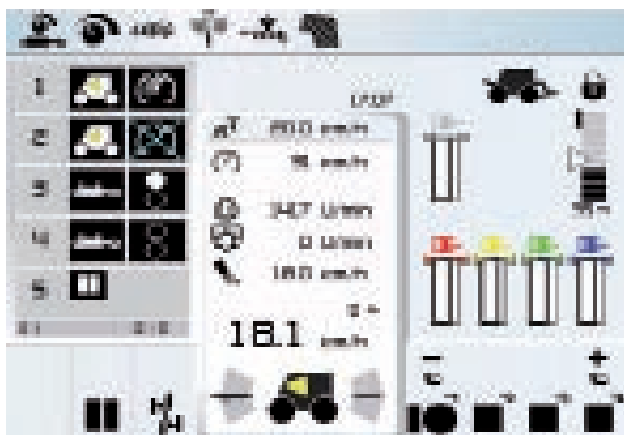

Right on course – to the nearest centimetre.



Advanced steering systems.

Since the introduction of GPS satellite technology in the agricultural industry, ever greater numbers of businesses in the sector have turned to the benefits of this system. Tractors equipped with the technology now enable operators to cash in on high-precision parallel guidance – day in, day out.

GPS PILOT.

Intelligent GPS technology puts an end to wastage of time and resources. With CLAAS GPS PILOT, you'll improve the precision of your farming operations and make significant cost savings.





Right on track.

The GPS PILOT uses a satellite signal to guide the machine securely and effortlessly in parallel directions of travel or along variable contours. The system helps the operator utilise the machine's full working width and reduces overlapping to achieve a higher work quality in a shorter time, irrespective of light or weather conditions.

GPS: for a good return on investment.

- Reduced fuel, operating, seed, pesticide and fertiliser costs
- Improved efficiency and productivity
- Maximum capacity utilisation and increased service life
- Reduced stress and burden on the driver
- Optimised exploitation of working width
- Significant improvement of work quality
- Consistent work quality around the clock
- Upgradable on any hydraulically steered machine
- More time for optimising your working implements

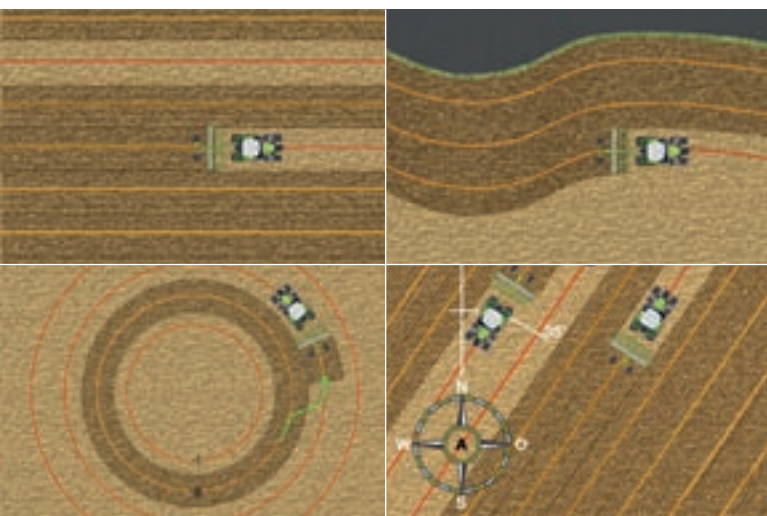

GPS PILOT



Unrivalled deployability.

- Oil-change intervals for gearbox, hydraulic system and axles are as long as 1,500 hours
- CEBIS indicates service status
- The bonnet and easily removable side panels provides easy access to all service points
- The front cooling pack swivels out on a hinge through 90°
- The air filter is readily accessible for cleaning between the axles on the right-hand side of the machine
- The hydraulic system offers excellent accessibility
- Engine-oil change after 400 hours

These features combine to make daily service and maintenance tasks much easier. Carried out regularly, these measures will safeguard the value of your machine.

No time to waste.



Servicing

CLAAS service – for when every minute counts.

We're there where you need us.

You can rely on the professional and dependable FIRST CLAAS SERVICE® team whenever you need us. CLAAS importers and sales partners provide optimum spare parts supply and reliable round-the-clock customer service worldwide.

You can count on us as and when you need parts in a hurry. Our central spare parts warehouse delivers all ORIGINAL CLAAS parts quickly and reliably all over the world. The extensive network of CLAAS dealers ensures that they reach their destination as quickly as possible – wherever you happen to be.





We speak the same language.

CLAAS dealers are highly trained and equipped with all the specialist tools required. Just as important is the fact that they also have intimate knowledge of the workings of your farm or contractor business, and know exactly what you expect in terms of skill and reliability.

We provide accurate diagnoses.

Many years of experience and the use of the most advanced diagnostic systems such as CDS 5000 enable our service engineers to pinpoint malfunctions in no time at all, and set up dependable configurations and download CEBIS updates.

An unrivalled machine –
the XERION.



XERION

3800 TRAC / TRAC VC

| Engine | | |
|--|-----------------|--|
| Caterpillar 6-cylinder engine, turbocharger, charge-air cooler | ● | |
| Cubic capacity | cm ³ | 8804 |
| Nominal engine speed | rpm | 2100 |
| Rated output at 2100 rpm as per ECE R 24 | kW/hp | 253/344 |
| Rated output at 2100 rpm as per ECE R 120 ¹ | kW/hp | 268/364 |
| Max. output at engine speed as per ECE R 24 | kW/hp at rpm | 279/379 at 1800 |
| Max. output at engine speed as per ECE R 120 ¹ | kW/hp at rpm | 285/388 at 1800 |
| Max. torque at engine speed | Nm at rpm | 1620 at 1400 |
| Fuel tank capacity | l | 620 |
| Transmission | | |
| ZF-ECCOM 3.5 | ● | |
| Infinitely variable CVT transmission | ● | |
| Max. speed in both directions | km/h | 50 |
| Rear PTO at 1000 rpm, PTO shaft stub | | 1¾" (20 splines and 6 splines) |
| Longitudinal differential | | 100% lockable, lamella construction |
| Powered steered axles | | |
| Differential locks | | 100% lockable, electrohydraulic actuation, lamella construction, with automatic function |
| Running gear | | |
| TRAC concept | | Four large, equal-sized wheels |
| Steering | | All-wheel steering, front-wheel/rear-wheel steering, crab steering |
| Weight distribution (front) | % | 53 |
| Weight distribution (rear) | % | 47 |
| Ballasting at 50 km/h (varies according to applicable national regulations) | t | up to 18 |
| Brakes | | |
| Service brake | | Hydraulically actuated wet multi-disc brakes, auxiliary power reinforced, acting on all wheels |
| Parking brake | | Electrohydraulically disengaged spring-loaded brake |
| Hydraulic system | | |
| Max. hydraulic tank capacity | l | 130 |
| Max. drawable volume | l | 80 |
| Main circuit (linkage, auxiliary spool valves) | | |
| Max. operating pressure | MPa/bar | 20/200 |
| Max. flow rate | l/min | 190 |
| Max. number of auxiliary spool valves | | 5 |
| Max. flow rate per disc | l/min | 110 |
| Max. hydraulic output | kW | 45 |
| Power hydraulic system (optional) | | |
| Operating pressure | bar | 260 |
| Max. flow rate at rated speed 2100 rpm | l/min | 235 |
| Max. power output (at min. 1200 rpm) | kW | 90 |

● Standard

¹ Performance data fit criteria for admissibility. Performance as per ECE R 120 corresponds to 97/68/EG and ISO TR 14396.

XERION

3800 TRAC / TRAC VC

| Connection unit | | |
|--|----|--|
| Automatic hitch, D38 bolts, spherical | kg | 2000 |
| Hitch with hitch ball, ball system 80 | kg | 3000 |
| Headstock, Piton Fix | kg | 3000 |
| Headstock with ball system 80 | kg | 4000 |
| Drawbar, short, D33, D40, D50 bolts | kg | 3000 |
| Drawbar with ball system 80 | kg | 3500 |
| Hitch ball behind cab, 110 mm | kg | 15,000 |
| CUNA D3, 50 mm | kg | 2500 |
| Front linkage | | |
| Lift capacity | | Category III N, dual-acting |
| Continuous | kN | 70 |
| Maximum | kN | 80 |
| Lifting range | mm | 841 |
| Shifting function | | Raising, lowering, float position |
| Rear linkage | | |
| Lift capacity | | Category IV N, dual-acting |
| Continuous | kN | 115 |
| Maximum | kN | 117 |
| Lifting range | mm | 756 |
| Shifting function | | Raising, lowering (pressing), float position |
| Control function | | Locational/tractional resistance, vibration damping |
| Dimensions and weights | | |
| Overall length without front weights (a) | mm | 6630 |
| Overall width | mm | min. 2490 |
| Overall height, depending on tyres (b) | mm | 3720 |
| Wheelbase (c) | mm | 3300 |
| Ground clearance, depending on equipment (d) | | 32" wheel diameter, 470 mm; 42" wheel diameter, 570 mm |
| Extremely small turning circle | m | 12 |
| Tare weight (without tyres) | kg | 10,200 |

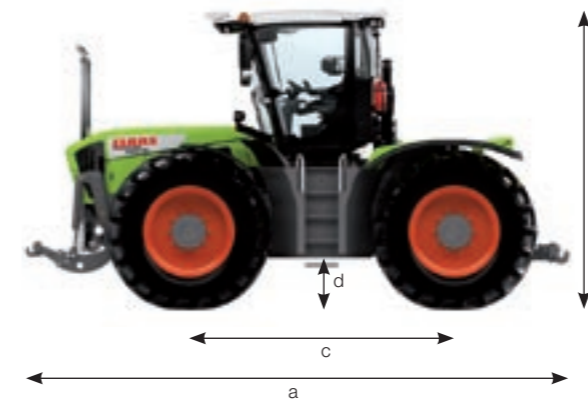

CLAAS continually develops its products to meet customer requirements. This means that all products are subject to change without notice. All descriptions and specifications in this brochure should be considered approximate and may include optional equipment that is not part of the standard specifications. This brochure is designed for worldwide use. Please refer to your nearest CLAAS dealer and their price list for local specification details. Some protective panels may have been removed for photographic purposes in order to present the function clearly. To avoid any risk of danger, never remove these protective panels yourself. In this respect, please refer to the relevant instructions in the operator's manual.

Outstanding features.

- Full chassis design for maximum load handling
- TRAC concept with four equal-sized tyres of up to 2.05 m
- 8.8-l 6-cylinder CAT engine with max. output of 279 kW / 379 hp
- Max. torque of 1,620 Nm
- Permanent all-wheel drive, axial differential, transverse differential
- 50 km/h at a fuel-saving, reduced engine speed
- Cruise control
- 18-t permissible overall weight, fully road-legal (varies according to applicable national regulations)
- High-performance hydraulic system with huge lift capacity
- Optional power hydraulics
- 4-wheel steering for maximum manoeuvrability
- Soil protection, thanks to automatic crab steering
- Rapid weight adjustment for the task at hand, thanks to simple ballasting
- Spacious cab
- CEBIS colour monitor – intuitive operation, quickly learned
- CLAAS GPS PILOT for precise parallel tracking, even at night
- Rotating cab for a perfect overview and comfort in either direction of travel
- Flexible use as a tractor or multi-configuration vehicle
- FIRST CLAAS SERVICE® around the clock

CLAAS UK
Saxham
Bury St. Edmunds
Suffolk
IP28 6QZ
Tel 01284 763100
claas.co.uk
info-uk@claas.com
301012131110 KK ME 0112

