



**Deluxe Seat**

The ergonomic designed fully adjustable suspension seat will allow the operator to ride in comfort no matter what the jobs may be.



**12x12 fully synchronized transmission**

The fully synchronized transmission provides smooth and easy shifting on the move. The transmission features 12 forward and 12 reverse gears to handle all kinds of jobs.



**Delightful internal surroundings**

The in&out air changer and air filter will keep the operator in delightful driving and working condition.

**Specifications**

MODEL	RX6010PC	RX6010C
<b>ENGINE</b>		
Manufacturer	Daedong	
Model	4B243TLWM-K	4B243TLWM
Engine Gross Power (HP)	59	
Rated speed (rpm)	2600	
Type	Water Cooled, 4Cycle, Turbo Diesel	
No. of cylinders	4	
Total displace (cc)	2435	
Turbo Charge	Turbo charged	
<b>CAPACITY</b>		
Fuel tank capacity (ℓ)	90	
Engine oil (Filter included) (ℓ)	7.7	
Engine coolant (ℓ)	9.1	
Transmission case (ℓ)	58	
Front axle case (ℓ)	8.5	
<b>PTO</b>		
PTO Power (HP)	49.1	
Rear PTO		
Revolution (rpm)	2nd : 540, 1000	
Type	Independent	
Mid PTO		
Revolution	-	
<b>HYDRAULIC</b>		
Lift Control Type : Standard	Position, Draft and Mixed Control	
3-point hitch	Category II	
Lift capacity at lift point (kg.f)	2378	
Cylinder type	Exterior	
No. of standard remote valves	1st, 2nd:STD., 3rd : Opt.	
<b>TRAVELLING SYSTEM</b>		
Transmission	PowerReverse 12F/12R	12F/12R
shuttle Type	Power shuttle	Synchro Shuttle
Steering	Hydrostatic power steering	
Brake	Wet multi disc type	
Main Clutch type	Multi wet disc clutch	Dry single disc clutch
Mechanical differential lock	Rear Standard	
4WD type	Hydraulic	
<b>TIRE SIZE</b>		
Front / Rear (AG.)	11.2-20 / 14.9-30	
Front / Rear (IND.)	12.5/80-18 / 18.4-24/8	
Front / Rear (TURF)	31X13.5X15/8 / 44X18X20/4	
<b>TRAVEL SPEEDS</b>		
Forward (km/h)_AG.	1.93~32.72	
Reverse (km/h)_AG.	1.90~32.17	
Forward (mph(km/h))_IND.	1.14 ~ 19.25 (1.83 ~30.98)	
Reverse (mph(km/h))_IND.	1.12 ~ 18.93 (1.80 ~ 30.46)	
<b>OTHER FEATURES</b>		
Tilt steering	Standard	
Hood type	One-Touch Hood type	
Deck type	full-flat	
Panel type	Electric	
<b>DIMENSIONS _IND.</b>		
Overall length (mm)	3700	
Overall width (min. tread) (mm)	1875	
Overall height (with CABIN) (mm)	2630	
Wheelbase (mm)	2100	
Min. ground clearance (mm)	420	
Min. turning radius(w/brake) (mm)	3110	
Weight (kg.f)	2610	

\*NOTE : The specifications are subject to change for the purpose of improvement without any notice.



Kioti Tractor/  
Daedong Industrial. Co., Ltd.  
1422-5, Seocho-Dong, Seocho-Ku, Seoul, Korea  
tel 82-2-3470-74549 • fax 82-2-3470-7485  
web www.daedong.co.kr



**Standard Equipment**

- Hydrostatic Power Steering
- Rear Differential Lock
- Hydraulic Brakes
- Adjustable Drawbar/Adjustable Seat
- Head Lights / Safety Lights
- Cup Holder
- Sunvisor
- 1st and 2nd Remote Hydraulic Valves
- Rear View Mirror
- 7 Pin Socket
- Draft Control
- Joystick Valve
- Auto 4WD
- Rear PTO
- Front Wiper
- CD Player

**Optional Equipment**

- 3rd Remote Hydraulic Valve
- Front Weights
- Rear Weights

Dealer Imprint Area



**KIOTI UTILITY TRACTOR**  
**RX6010C / RX6010PC**







# RX6010C/RX6010PC series



### Power Shuttle Lever(RX6010PC)

The Power Shuttle Lever provides easy forward and reverse operation without stepping on a clutch pedal.



### Power & Tilt Steering wheel

The fully synchronized transmission provides smooth and easy shifting on the move. The transmission features 12 forward and 12 reverse gears to handle all kinds of jobs.



### Remote hydraulic valve

Standard dual remote hydraulic valves (3rd optional) accommodate a wide variety of attachments and implements. The Mid mount hydraulics and a single lever joystick for loader operations are standard on the RX series.



### AUTO & Hydraulic PTO

The standard rear PTO is easily engaged by the simple push of button and selecting either manual or automatic operation. For added safety, the AUTO PTO function can be selected to automatically stop the PTO when the implement is raised by the control lever; eliminating exposure to the moving parts. A safety interlock prevents engine start when the PTO switch is left on.

### Front Glass

The front glass with upgraded sealing method will grant best field vision with better noise protection.

### Luxury Cabin

The new comfortable cabin with upgraded interior will minimize operators fatigue even after long days of work.



### External Hydraulic Cylinder

The RX series tractor has two external hydraulic lift cylinders (left and right) with highest lift capacity of 2,378 kg.f among its same class level tractors providing easiest condition for the maintenance.



### New elegant Grill and Hood

New streamlined hood design improves visibility of the operator. The 60 degrees hood opening angle enables convenient access for better maintenance.



### Powerful Environmentally Friendly Turbo Engine

The powerful 59hp Turbo Engine will offer operator quietest, smoothest but most powerful working condition.

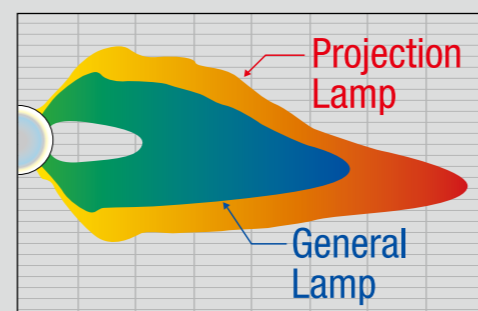

### New Projection Head lamp

With the new projection headlamp and working lamp, the operator will experience safer and easier operation in the dark operating condition.



### Hydraulic 4WD

Front wheel driving is easily engaged by hydraulic clutch.

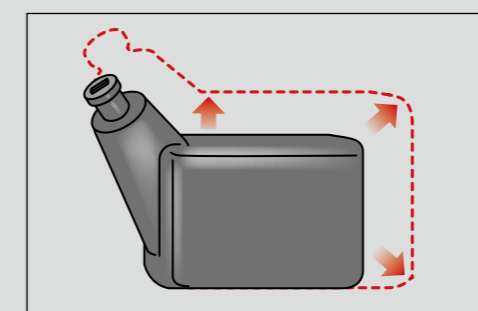

### Fuel Tank(90ℓ)

Thanks to 90 liter fuel tank, which allows to work enough hours without frequent re-fueling.